



117 Waikiki Road Bonnells Bay NSW

3 2 2

This stunning single level home combines simplicity with style, making it the perfect home for families or retirees. The private backyard offers the perfect setting for entertaining family and friends amongst the Japanese styled gardens. Featuring three large bedrooms with a large walk-in-robe and ensuite in the main bedroom. Capture all day sunlight and lake breezes from the private elevated position, whilst set in a friendly neighbourhood where most of the residents enjoy a gentle short stroll to the stunning water's edge of the extensive waterfront reserve with public jetty nearby.

Highlights include;

- Separate living area and covered alfresco dining
- Landscaped yard with well established Japanese styled gardens
- Ducted air-conditioning, ceiling fans and ample storage throughout
- Indoor living flows effortlessly to outdoor alfresco entertaining

Situated in the highly sought after Waikiki Estate the property is just moments from local parks, boat ramp, and

Price : Guide: \$875,000 to \$925,000
Land Size : 714 sqm
View : <https://www.lawsonre.com.au/7992953>

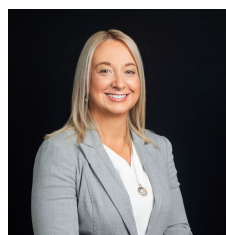

Kerrie Wright
02 4973 3111

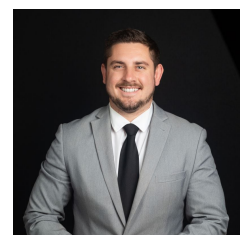

Mitchell Petty
02 4973 3111

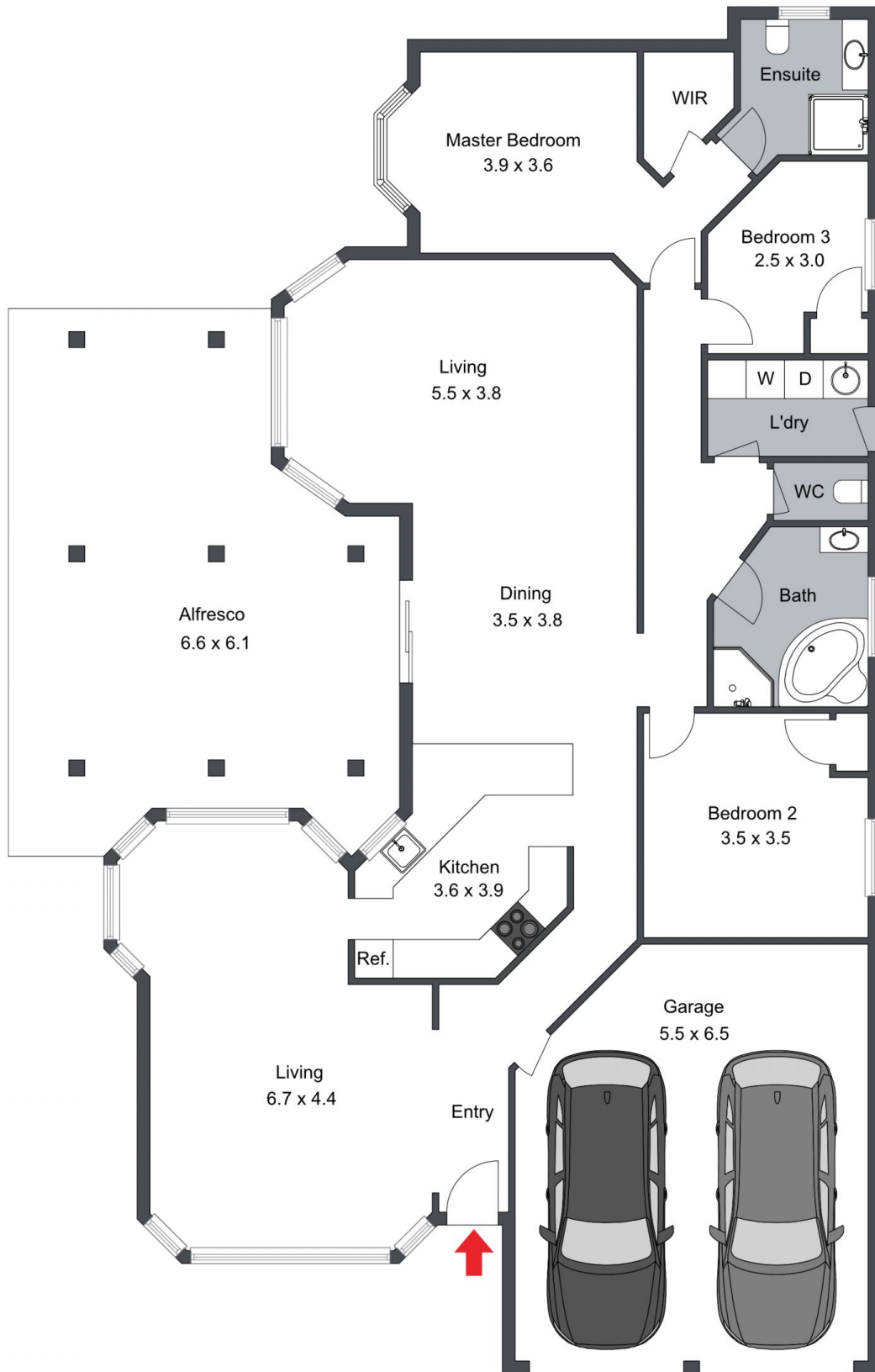

117 Waikiki Road, Bonnells Bay

The floor plan is not to scale; measurements are indicative and in metres. Exterior elements are not in position. Plans should not be relied on. Interested parties should make and rely on their own enquiries.



117 Waikiki Road, Bonnells Bay

The floor plan is not to scale; measurements are indicative and in metres. All features included in this 3D plan are for inspiration purposes only. This is not an exact replica of the property or the position of exterior elements. Plans should not be relied on. Interested parties should make and rely on their own enquiries.

Produced by **DIAKRIT**